

FOUR STAGE CLEARANCE TEST REPORT

Job Number: J370871/CO01

Job Number	J370871/CO01	Report Date	09 Dec 2018
Customer Name	Amstech Asbestos Removals Ltd	Contractor	Amstech Asbestos Removals Ltd, Unit F, Rich Industrial Estate, Avis Way, Newhaven, East Sussex, BN9 0DU
Customer Address	Unit F, Rich Industrial Estate, Avis Way, Newhaven, East Sussex, BN9 0DU	Site Address	Dove Lodge Community Resources Centre, 49 Beach Road, Littlehampton, West Sussex, BN17 5JG

Scope of Works

Brief Description of Work / Type of ACM / Location of ACM and Work Area / Any ACM to Remain by Design:

4 stage clearance carried out following the removal of Asbestos insulating board stair backing panel from within enclosure 1.

I confirm that the scope of works has been completed and is ready for 4 Stage Clearance testing. *

Site Supervisor Name Jamie Crabb

Signature



Date 09 Dec 2018

Time 12:10

STAGE 1 - Preliminary Check of Site Conditions and Job Completeness

Start Time	12:10	Finish Time	12:25
1. Method statement (Plan of work) on site and checked	Yes	2. DCU intact, operational and clean	Yes
3. Transit route free from obvious ACMs	Yes	4. Waste route free from obvious ACMs	Yes
5. Surrounding areas free from obvious ACMs	Yes	6. Negative pressure unit in situ and operational	Yes
7. Viewing panel fitted / CCTV (no if visibility is limited)	Yes	8. Integrity of enclosure/work area checked and satisfactory	Yes
9. Waste disposal / storage area checked and satisfactory	Yes	10. Previous air / smoke testing carried out (state)	

/ smoke testing carried out (state)

N/A

Comments

Method statement checked and works are as described, Transit and waste route checked and no ACMs are in situ, Surrounding area's have been checked within reason and no obvious ACMs are in situ, Viewing panel and CCTV fitted to allow full view of the enclosure, integrity of the area is sound and sufficient for works, Waste unit checked and appropriate, DCU operational and clean with correct certifications, NPU is operating correctly.

For and on behalf of Tersus Consultancy Ltd.

Conor Hewett

Signature



Date 09 Dec 2018

Time 12:25

Site assessment for reoccupation (4 Stage Clearance) comprises four stages of assessment, undertaken to satisfy current asbestos regulations, resulting in the issue of a Certificate of Reoccupation (CoR). In some cases Stage 3 (air testing) may be omitted as stated in L143, paragraph 284, when requested by the customer. In this case this will be clearly stated on the test report. Clearance (C), static samples are taken in order to assess an environment to the clearance indicator (as part of the CoR process and for decontamination units). Any deviations to these standard tests shall be recorded as appropriate.

STAGE 2 - Visual Inspection

Start Time	12:27	Finish Time	12:40
11. All ACMs removed according to plan of work, dust debris contaminated clothing etc:	Yes	16. Dust and debris in enclosure and airlocks, or work area	No
12. Enclosure and airlocks, or work area dry	Yes	17. Negative Pressure unit switched on	Yes
13. Presence of sprayed sealant	No	18. ACMs to remain (by design as noted on stage 1)	N/A
14. Inaccessible areas (if yes please indicate on diagram)	No	19. Number of visuals undertaken	
. Number of visuals undertaken		1	

Approximate Area/Enclosure dimensions Length: 1.8 m Width:2 m Height:1.8 m Approx. Area:3.6 m² Approx. Volume:6.48 m³

Site Plan

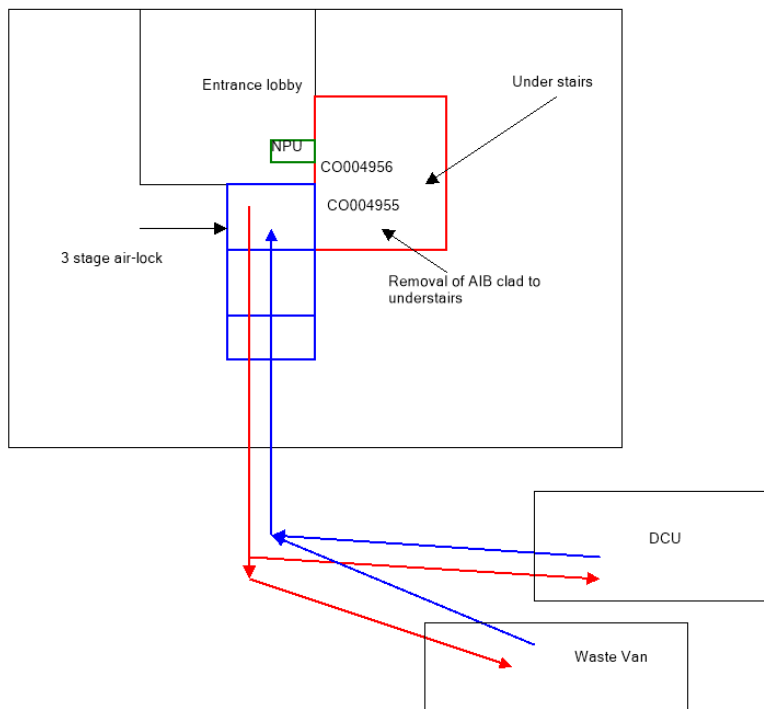

For and on behalf of Tersus Consultancy Ltd.

Conor Hewett

Signature

Date

09 Dec 2018

Time

12:40

Site Address		Dove Lodge Community Resources Centre, 49 Beach Road, Littlehampton, West Sussex, BN17 5JG																
Lab location / Veh. Reg.		Mobile Lab			Respirator type			Half Mask and Full Face			Filter Diameter			22 mm				
Flow meter reference		SFM 02			Micrometer reference			SM 04										
HSE/NPL Test slide ref.												29/214						
Microscope reference												Graticule diameter			100 µm			
Timer reference			BTT 09			Filter box reference			441			Centred and block 5 visible			Yes			
Sample ref	Sample (s) location	Pump ref	Filter Head ref	Temp (°C)	Pressure (mb)	Flow Rate Start	Sample Start Time	Brush Disturbance (mins)	Sample Stop Time	Flow Rate Stop	Duration (mins)	Sample Volume (l)	Average Flow Rate	Fibres	Fields	Limit of Detection (f/ml)	Calculated Result (f/ml)	Reported Result (f/ml)
CO004955	Under stairs	BF-20	CH7	12	994	8.2	12:41	12:41 12:44	13:12	8.2	31	254	8.2	4	200	0.01	0.0042	<0.01
CO004956	Under stairs	BF-20	CH3	12	994	8.3	12:41	12:41 12:44	13:12	8.4	31	259	8.4	5	200			
CO004957	Field Blank	N/A	CH9	12	994	N/A	N/A	N/A	N/A	N/A	N/A	N/A	N/A			Field Blank		

Comments:

N/A

REPORTING RESULTS: These results have been obtained and reported under the requirements of our UKAS accreditation to ISO 17025:2005, applying the methods as detailed in HSG248. WHO fibre counting rules are applied, as detailed in HSG248. At least 20 fields must be read, and counting stops when either 100 fibres or 200 fields is reached. The number of fields counted may be reduced where the volume is greater than 480 litres. Opinions and interpretations based on test results are outside the scope of UKAS accreditation. Where the results are < 0.010 f/ml the area has passed relative to the clearance indicator as required for CoR. At least 80% of the results should be < 0.010 f/ml, and all should be < 0.015 f/ml. Results are calculated to three decimal places to distinguish between 0.009 f/l (which is acceptable) and 0.010 f/ml (which is unacceptable). If the sample appears to be uncountable or biased this statement and reasoning shall be noted on the report. Uncertainty budget: sampling and analysis is performed to an estimated level of confidence of 95%.
 ABBREVIATIONS f/ml: fibres per millilitre of air, l: litre, m: metre, °C: centigrade, mb: millibar, N/A: Not Applicable, NPU: Negative Pressure Unit, FMB Field Media Blank (media check).
 FILTER EVALUATION: Discrimination between asbestos and non-asbestos fibres is NOT undertaken in the application of the method for filter evaluation.

For and on behalf of Tersus Consultancy Ltd.

Conor Hewett

Signature



Date 09 Dec 2018

Time 13:37

Comments:

Area built up using 1000gauge polythene and a 3 stage air-lock which connects directly onto the understairs cupboard outside the entrance lobby, Air-locks are clean and dust free, upon entering the enclosure the area has been removed entirely of AIB and all ACMs down in the plan of works to remove, please note that remaining boarding is plasterboard and not an ACM, all timbers that had AIB attached have been drilled out and wire brused, this includes but not limited to the timbers directly adjacent as you walk under the understairs cupboard, all electrical units have been cleaned and are satisfactory, please note no access within the electrical units. floors and walls have been cleaned and are dust and debris free. Area satisfactory for pass of stage 2.

STAGE 3 - Air Monitoring

29. Measurements required	1	30. No of measurements taken	1
31. NPU off and sealed	Yes	32. Areas of limited dust disturbance (state)	
ate)			N/A

STAGE 4 - Final assessment post enclsoure/work area dismantling

33. Enclosure, airlocks or designated work area removed completely	Yes	34. Former enclosure or work area free of dust and debris	Yes
35. Transit route free from obvious ACM	Yes	36. Waste route free from obvious ACM	Yes
37. Where ACM remains by design, is it in a good condition?	Yes	38. Further remedial action required	No
39. Surrounding areas free from obvious ACM	Yes	40. Does the decontamination unit require testing	
unit require testing			Yes

Comments

4 stage clearance complete, all polythene has been removed in it's entirety, where polythene has been removed behind has been checked, no ACMs remain, area is dust and debris free.

For and on behalf of Tersus Consultancy Ltd.

Conor Hewett

Signature



Date 09 Dec 2018

Time 14:00

Contractor/Customer acknowledgement

Name Jamie Crabb

Company/Organisation Amstech Asbestos Removals Ltd

Signature



Date 09 Dec 2018

Certificate for Reoccupation

Job Number: J370871/CO01

Job Number	J370871/CO01	Report Date	09 Dec 2018
Customer Name	Amstech Asbestos Removals Ltd	Contractor	Amstech Asbestos Removals Ltd, Unit F, Rich Industrial Estate, Avis Way, Newhaven, East Sussex, BN9 0DU
Customer Address	Unit F, Rich Industrial Estate, Avis Way, Newhaven, East Sussex, BN9 0DU	Site Address	Dove Lodge Community Resources Centre, 49 Beach Road, Littlehampton, West Sussex, BN17 5JG
Enclosure Location / Work Area		4 stage clearance carried out following the removal of Asbestos insulating board stair backing panel from within enclosure 1.	

STAGE 1 OF 4 - PRELIMINARY SITE ASSESSMENT Précis of assessment criteria		
SCOPE OF WORK / METHOD STATEMENT PRESENT ALL WORKS WITHIN SCOPE COMPLETED WORK AREA ENCLOSURE AND AIRLOCKS INTACT AND CLEAN AIR EXTRACTION UNIT OPERABLE HYGIENE FACILITIES OPERATING AND CLEAN AREA SURROUNDING ENCLOSURE CLEAN TRANSIT ROUTE CLEAN WASTE ROUTE & DISPOSAL AREA CLEAN	SATISFACTORY	As Detailed on Report 'Preliminary Check of Site Conditions and Job Completeness'
STAGE 2 OF 4 - VISUAL INSPECTION Précis of assessment criteria		
AIR LOCKS CLEAR OF DEBRIS AND CLEAN ENCLOSURE / WORK AREA CLEAR OF DUST AND DEBRIS ALL SPECIFIED WORKS UNDERTAKEN	SATISFACTORY	As Detailed on Report 'Visual Inspection'
STAGE 3 OF 4 - AIR MONITORING Précis of assessment criteria		
DETERMINATION OF AIRBORNE FIBRE CONCENTRATION RESULTS TO THE CLEARANCE INDICATOR (0.01f/ml)	SATISFACTORY	As Detailed on Report 'Determination of Airborne Fibre Concentrations'
STAGE 4 OF 4 - FINAL SITE ASSESSMENT Précis of assessment criteria		
ENCLOSURE AND AIR LOCKS REMOVED FORMER WORK AREA FREE FROM DUST AND DEBRIS TRANSIT ROUTE CLEAN WASTE ROUTE CLEAN REMAINING ACMs IN GOOD CONDITION	SATISFACTORY	As Detailed on Report 'Final Assessment - Post Enclosure/Work Area Dismantling'
Reason for Sampling 4 stage clearance carried out following the removal of Asbestos insulating board stair backing panel from within enclosure 1.		

For and on behalf of Tersus Consultancy Ltd.

I CONFIRM THAT THE FORMER WORK AREA / ENCLOSURE LOCATION DESCRIBED IS CLASSED AS SAFE FOR REOCCUPATION

Signature



Conor Hewett

Notes: This certificate is not complete unless a copy of the results of the individual stages is appended.

CONTRACTOR / CUSTOMER ACKNOWLEDGEMENT

Signature



Jamie Crabb

FOUR STAGE CLEARANCE TEST REPORT

Job Number: J370870/CO01

Job Number	J370870/CO01	Report Date	08 Dec 2018
Customer Name	Amstech Asbestos Removals Ltd	Contractor	Amstech Asbestos Removals Ltd, Unit F, Rich Industrial Estate, Avis Way, Newhaven, East Sussex, BN9 0DU
Customer Address	Unit F, Rich Industrial Estate, Avis Way, Newhaven, East Sussex, BN9 0DU	Site Address	Dove Lodge Community Resources Centre, 49 Beach Road, Littlehampton, West Sussex, BN17 5JG

Scope of Works

Brief Description of Work / Type of ACM / Location of ACM and Work Area / Any ACM to Remain by Design:

4 stage clearance carried out following the removal of AIB ceiling to external porchway, enclosure 3.

I confirm that the scope of works has been completed and is ready for 4 Stage Clearance testing. *

Site Supervisor Name Jamie Crabb

Signature



Date 08 Dec 2018

Time 11:45

STAGE 1 - Preliminary Check of Site Conditions and Job Completeness

Start Time	11:45	Finish Time	12:00
1. Method statement (Plan of work) on site and checked	Yes	2. DCU intact, operational and clean	Yes
3. Transit route free from obvious ACMs	Yes	4. Waste route free from obvious ACMs	Yes
5. Surrounding areas free from obvious ACMs	Yes	6. Negative pressure unit in situ and operational	Yes
7. Viewing panel fitted / CCTV (no if visibility is limited)	Yes	8. Integrity of enclosure/work area checked and satisfactory	Yes
9. Waste disposal / storage area checked and satisfactory	Yes	10. Previous air / smoke testing carried out (state)	

/ smoke testing carried out (state)

N/A

Comments

Method statement checked and works are as described, transit and waste route have been checked and no obvious ACMs are in situ, DCU has been checked and is clean and operational with all the correct certification, Viewing panel and CCTV fitted to both enclosures to be done today, please see report 2, surrounding area's have been checked within reason and no obvious ACMs are in situ, Integrity of both work area's are satisfactory and sound. Stage 1 passed.

For and on behalf of Tersus Consultancy Ltd.

Conor Hewett

Signature



Date 08 Dec 2018

Time 12:00

Site assessment for reoccupation (4 Stage Clearance) comprises four stages of assessment, undertaken to satisfy current asbestos regulations, resulting in the issue of a Certificate of Reoccupation (CoR). In some cases Stage 3 (air testing) may be omitted as stated in L143, paragraph 284, when requested by the customer. In this case this will be clearly stated on the test report. Clearance (C), static samples are taken in order to assess an environment to the clearance indicator (as part of the CoR process and for decontamination units). Any deviations to these standard tests shall be recorded as appropriate.

STAGE 2 - Visual Inspection

Start Time	12:03	Finish Time	12:18
11. All ACMs removed according to plan of work, dust debris contaminated clothing etc:	Yes	16. Dust and debris in enclosure and airlocks, or work area	No
12. Enclosure and airlocks, or work area dry	Yes	17. Negative Pressure unit switched on	Yes
13. Presence of sprayed sealant	No	18. ACMs to remain (by design as noted on stage 1)	N/A
14. Inaccessible areas (if yes please indicate on diagram)	No	19. Number of visuals undertaken	
. Number of visuals undertaken		1	

Approximate Area/Enclosure dimensions Length: 1 m Width:1 m Height:1.8 m Approx. Area:1 m² Approx. Volume:1.8 m³

Site Plan

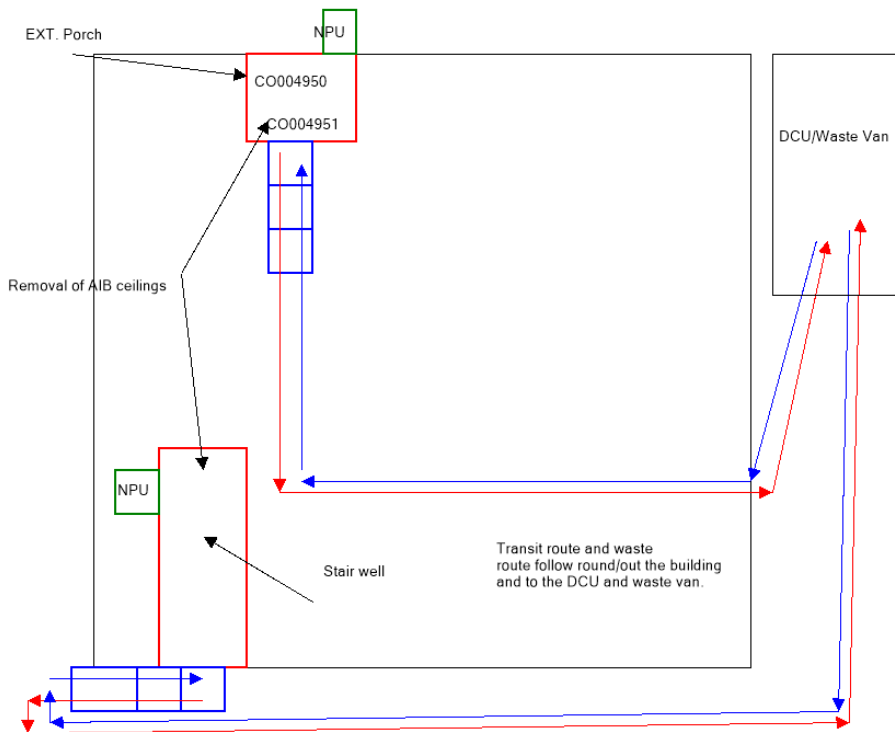

For and on behalf of Tersus Consultancy Ltd.

Conor Hewett

Signature

Date

08 Dec 2018

Time

12:18

Site Address				Dove Lodge Community Resources Centre, 49 Beach Road, Littlehampton, West Sussex, BN17 5JG														
Lab location / Veh. Reg.				Mobile Lab			Respirator type			Half Mask and Full Face			Filter Diameter			22 mm		
Flow meter reference				SFM 02			Micrometer reference			SM 04								
HSE/NPL Test slide ref.												29/214						
Microscope reference												Graticule diameter			100 µm			
Timer reference				BTT 09			Filter box reference			441			Centred and block 5 visible			Yes		
Sample ref	Sample (s) location	Pump ref	Filter Head ref	Temp (°C)	Pressure (mb)	Flow Rate Start	Sample Start Time	Brush Disturbance (mins)	Sample Stop Time	Flow Rate Stop	Duration (mins)	Sample Volume (l)	Average Flow Rate	Fibres	Fields	Limit of Detection (f/ml)	Calculated Result (f/ml)	Reported Result (f/ml)
CO004950	Ext. Porch	BF-20	CH7	13	1010	8.2	12:20	12:20 12:23	12:51	8.3	31	256	8.3	3	200	0.01	0.0021	<0.01
CO004951	Ext. Porch	BF-20	CH8	13	1010	8.2	12:20	12:20 12:23	12:51	8.3	31	256	8.3	1.5	200			
CO004952	Field Blank	N/A	CH11	13	1010	N/A	N/A	N/A	N/A	N/A	N/A	N/A	N/A			Field Blank		

Comments:

N/A

REPORTING RESULTS: These results have been obtained and reported under the requirements of our UKAS accreditation to ISO 17025:2005, applying the methods as detailed in HSG248. WHO fibre counting rules are applied, as detailed in HSG248. At least 20 fields must be read, and counting stops when either 100 fibres or 200 fields is reached. The number of fields counted may be reduced where the volume is greater than 480 litres. Opinions and interpretations based on test results are outside the scope of UKAS accreditation. Where the results are < 0.010 f/ml the area has passed relative to the clearance indicator as required for CoR. At least 80% of the results should be < 0.010 f/ml, and all should be < 0.015 f/ml. Results are calculated to three decimal places to distinguish between 0.009 f/l (which is acceptable) and 0.010 f/ml (which is unacceptable). If the sample appears to be uncountable or biased this statement and reasoning shall be noted on the report. Uncertainty budget: sampling and analysis is performed to an estimated level of confidence of 95%.
 ABBREVIATIONS f/ml: fibres per millilitre of air, l: litre, m: metre, °C: centigrade, mb: millibar, N/A: Not Applicable, NPU: Negative Pressure Unit, FMB Field Media Blank (media check).
 FILTER EVALUATION: Discrimination between asbestos and non-asbestos fibres is NOT undertaken in the application of the method for filter evaluation.

For and on behalf of Tersus Consultancy Ltd.

Conor Hewett

Signature



Date 08 Dec 2018

Time 13:13

Comments:

Area built up using 1000gauge polythene and a 3 stage air-lock which is built directly onto the external porch from the inside, all polythene within the 3 stage air-locks have been cleaned and are of a satisfactory standard, upon entering the external porch it's clear to see the viewing panel and NPU are working properly and allowing full view of the area, all timber beams have been wire brushed and drilled out to ensure no debris or dust are in situ, area clean and dust free. No ACMs remain, brick walls have been cleaned and are free of debris or dust, concrete flooring has been cleaned and is clear of debris or dust, area satisfactory.

STAGE 3 - Air Monitoring

29. Measurements required	1	30. No of measurements taken	1
31. NPU off and sealed	Yes	32. Areas of limited dust disturbance (state)	
ate)			Yes

STAGE 4 - Final assessment post enclosure/work area dismantling

33. Enclosure, airlocks or designated work area removed completely	Yes	34. Former enclosure or work area free of dust and debris	Yes
35. Transit route free from obvious ACM	Yes	36. Waste route free from obvious ACM	Yes
37. Where ACM remains by design, is it in a good condition?	N/A	38. Further remedial action required	N/A
39. Surrounding areas free from obvious ACM	Yes	40. Does the decontamination unit require testing	
unit require testing			N/A

Comments

All polythene has been removed satisfactory, no resemblance of any asbestos removal remains, area is clean and dust free, satisfactory for re-occupation.

For and on behalf of Tersus Consultancy Ltd.

Conor Hewett

Signature



Date 08 Dec 2018

Time 14:10

Contractor/Customer acknowledgement

Name Jamie Crabb

Company/Organisation Amstech Asbestos Removals Ltd

Signature



Date 08 Dec 2018

Certificate for Reoccupation

Job Number: J370870/CO01

Job Number	J370870/CO01	Report Date	09 Dec 2018
Customer Name	Amstech Asbestos Removals Ltd	Contractor	Amstech Asbestos Removals Ltd, Unit F, Rich Industrial Estate, Avis Way, Newhaven, East Sussex, BN9 0DU
Customer Address	Unit F, Rich Industrial Estate, Avis Way, Newhaven, East Sussex, BN9 0DU	Site Address	Dove Lodge Community Resources Centre, 49 Beach Road, Littlehampton, West Sussex, BN17 5JG
Enclosure Location / Work Area		4 stage clearance carried out following the removal of AIB ceiling to external porchway, enclosure 3.	

STAGE 1 OF 4 - PRELIMINARY SITE ASSESSMENT Précis of assessment criteria		
SCOPE OF WORK / METHOD STATEMENT PRESENT ALL WORKS WITHIN SCOPE COMPLETED WORK AREA ENCLOSURE AND AIRLOCKS INTACT AND CLEAN AIR EXTRACTION UNIT OPERABLE HYGIENE FACILITIES OPERATING AND CLEAN AREA SURROUNDING ENCLOSURE CLEAN TRANSIT ROUTE CLEAN WASTE ROUTE & DISPOSAL AREA CLEAN	SATISFACTORY	As Detailed on Report 'Preliminary Check of Site Conditions and Job Completeness'
STAGE 2 OF 4 - VISUAL INSPECTION Précis of assessment criteria		
AIR LOCKS CLEAR OF DEBRIS AND CLEAN ENCLOSURE / WORK AREA CLEAR OF DUST AND DEBRIS ALL SPECIFIED WORKS UNDERTAKEN	SATISFACTORY	As Detailed on Report 'Visual Inspection'
STAGE 3 OF 4 - AIR MONITORING Précis of assessment criteria		
DETERMINATION OF AIRBORNE FIBRE CONCENTRATION RESULTS TO THE CLEARANCE INDICATOR (0.01f/ml)	SATISFACTORY	As Detailed on Report 'Determination of Airborne Fibre Concentrations'
STAGE 4 OF 4 - FINAL SITE ASSESSMENT Précis of assessment criteria		
ENCLOSURE AND AIR LOCKS REMOVED FORMER WORK AREA FREE FROM DUST AND DEBRIS TRANSIT ROUTE CLEAN WASTE ROUTE CLEAN REMAINING ACMs IN GOOD CONDITION	SATISFACTORY	As Detailed on Report 'Final Assesment - Post Enclosure/Work Area Dismantling'
Reason for Sampling 4 stage clearance carried out following the removal of AIB ceiling to external porchway, enclosure 3.		

For and on behalf of Tersus Consultancy Ltd.

I CONFIRM THAT THE FORMER WORK AREA / ENCLOSURE LOCATION DESCRIBED IS CLASSED AS SAFE FOR REOCCUPATION

Signature



Conor Hewett

Notes: This certificate is not complete unless a copy of the results of the individual stages is appended.

CONTRACTOR / CUSTOMER ACKNOWLEDGEMENT

Signature



Jamie Crabb

FOUR STAGE CLEARANCE TEST REPORT

Job Number: J370870/CO02

Job Number	J370870/CO02	Report Date	08 Dec 2018
Customer Name	Amstech Asbestos Removals Ltd	Contractor	Amstech Asbestos Removals Ltd, Unit F, Rich Industrial Estate, Avis Way, Newhaven, East Sussex, BN9 0DU
Customer Address	Unit F, Rich Industrial Estate, Avis Way, Newhaven, East Sussex, BN9 0DU	Site Address	Dove Lodge Community Resources Centre, 49 Beach Road, Littlehampton, West Sussex, BN17 5JG

Scope of Works

Brief Description of Work / Type of ACM / Location of ACM and Work Area / Any ACM to Remain by Design:

4 stage clearance carried out following the removal of Asbestos insulating board ceiling to the stairwell.

I confirm that the scope of works has been completed and is ready for 4 Stage Clearance testing. *

Site Supervisor Name Jamie Crabb

Signature



Date 08 Dec 2018

Time 11:50

STAGE 1 - Preliminary Check of Site Conditions and Job Completeness

Start Time	11:50	Finish Time	12:05
1. Method statement (Plan of work) on site and checked	Yes	2. DCU intact, operational and clean	Yes
3. Transit route free from obvious ACMs	Yes	4. Waste route free from obvious ACMs	Yes
5. Surrounding areas free from obvious ACMs	Yes	6. Negative pressure unit in situ and operational	Yes
7. Viewing panel fitted / CCTV (no if visibility is limited)	Yes	8. Integrity of enclosure/work area checked and satisfactory	Yes
9. Waste disposal / storage area checked and satisfactory	Yes	10. Previous air / smoke testing carried out (state)	

/ smoke testing carried out (state)

N/A

Comments

Method statement checked and works are as described, transit and waste route have been checked and no obvious ACMs are in situ, DCU has been checked and is clean and operational with all the correct certification, Viewing panel and CCTV fitted to both enclosures to be done today, please see report 2, surrounding area's have been checked within reason and no obvious ACMs are in situ, Integrity of both work area's are satisfactory and sound. Stage 1 passed.

For and on behalf of Tersus Consultancy Ltd.

Conor Hewett

Signature



Date 08 Dec 2018

Time 12:05

Site assessment for reoccupation (4 Stage Clearance) comprises four stages of assessment, undertaken to satisfy current asbestos regulations, resulting in the issue of a Certificate of Reoccupation (CoR). In some cases Stage 3 (air testing) may be omitted as stated in L143, paragraph 284, when requested by the customer. In this case this will be clearly stated on the test report. Clearance (C), static samples are taken in order to assess an environment to the clearance indicator (as part of the CoR process and for decontamination units). Any deviations to these standard tests shall be recorded as appropriate.

STAGE 2 - Visual Inspection

Start Time	12:25	Finish Time	12:42
11. All ACMs removed according to plan of work, dust debris contaminated clothing etc:	Yes	16. Dust and debris in enclosure and airlocks, or work area	No
12. Enclosure and airlocks, or work area dry	Yes	17. Negative Pressure unit switched on	Yes
13. Presence of sprayed sealant	No	18. ACMs to remain (by design as noted on stage 1)	N/A
14. Inaccessible areas (if yes please indicate on diagram)	N/A	19. Number of visuals undertaken	
. Number of visuals undertaken		1	

Approximate Area/Enclosure dimensions Length: 6 m Width:1 m Height:1.5 m Approx. Area:6 m² Approx. Volume:9.0 m³

Site Plan

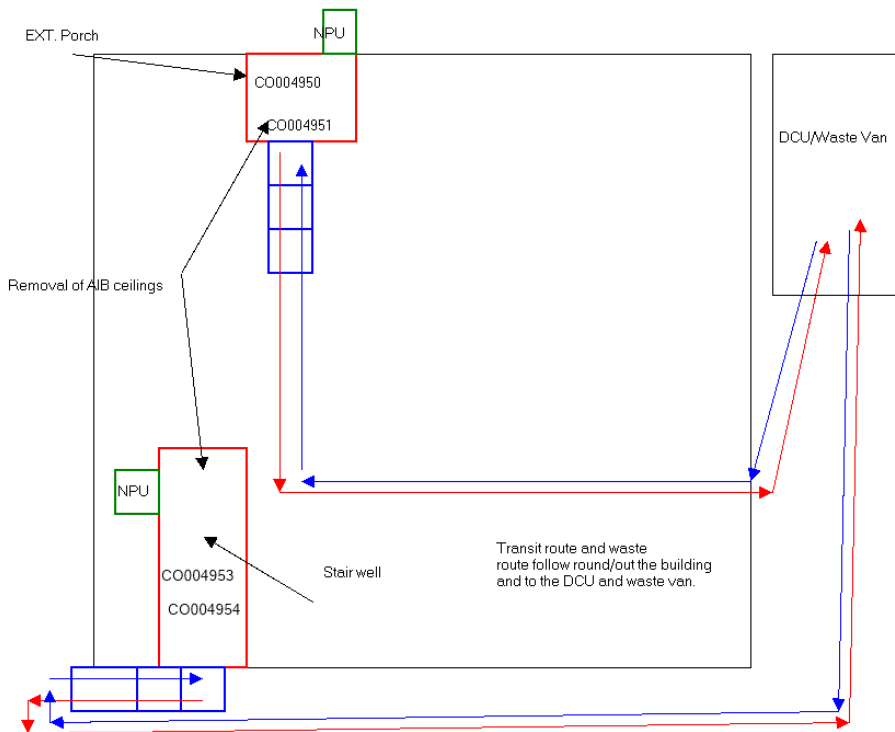

For and on behalf of Tersus Consultancy Ltd.

Conor Hewett

Signature

Date

08 Dec 2018

Time

12:43

Site Address				Dove Lodge Community Resources Centre, 49 Beach Road, Littlehampton, West Sussex, BN17 5JG															
Lab location / Veh. Reg.				Mobile Lab			Respirator type			Half Mask and Full Face			Filter Diameter			22 mm			
Flow meter reference				SFM 02			Micrometer reference			SM 04									
HSE/NPL Test slide ref.												29/214							
Microscope reference												Graticule diameter			100 µm				
Timer reference				BTT 09			Filter box reference			441			Centred and block 5 visible			Yes			
Sample ref	Sample(s) location	Pump ref	Filter Head ref	Temp (°C)	Pressure (mb)	Flow Rate Start	Sample Start Time	Brush Disturbance (mins)	Sample Stop Time	Flow Rate Stop	Duration (mins)	Sample Volume (l)	Average Flow Rate	Fibres	Fields	Limit of Detection (f/ml)	Calculated Result (f/ml)	Reported Result (f/ml)	
CO004953	Stairwell	BF-15	CH2	12	996	8.2	12:43	12:43 12:46	13:16	8.3	33	272	8.3	3	200	0.01	0.0033	<0.01	
CO004954	Stairwell	BF-15	CH10	12	996	8.2	12:43	12:43 12:46	13:16	8.2	33	271	8.2	4.5	200				

Comments:

N/A

REPORTING RESULTS: These results have been obtained and reported under the requirements of our UKAS accreditation to ISO 17025:2005, applying the methods as detailed in HSG248. WHO fibre counting rules are applied, as detailed in HSG248. At least 20 fields must be read, and counting stops when either 100 fibres or 200 fields is reached. The number of fields counted may be reduced where the volume is greater than 480 litres. Opinions and interpretations based on test results are outside the scope of UKAS accreditation. Where the results are < 0.010 f/ml the area has passed relative to the clearance indicator as required for CoR. At least 80% of the results should be < 0.010 f/ml, and all should be < 0.015 f/ml. Results are calculated to three decimal places to distinguish between 0.009 f/l (which is acceptable) and 0.010 f/ml (which is unacceptable). If the sample appears to be uncountable or biased this statement and reasoning shall be noted on the report. Uncertainty budget: sampling and analysis is performed to an estimated level of confidence of 95%.
 ABBREVIATIONS f/ml: fibres per millilitre of air, l: litre, m: metre, °C: centigrade, mb: millibar, N/A: Not Applicable, NPU: Negative Pressure Unit, FMB Field Media Blank (media check).
 FILTER EVALUATION: Discrimination between asbestos and non-asbestos fibres is NOT undertaken in the application of the method for filter evaluation.

For and on behalf of Tersus Consultancy Ltd.

Conor Hewett

Signature



Date 08 Dec 2018

Time 13:35

Comments:

Area built up using 1000gauge polythene and a 3 stage air-lock which is built on the outside of the building leading into the stair well, 3 stage air-lock is clean and clear of any debris and dust all waste bags have been removed along with all tools used for removal, the stair well itself has had all the asbestos containing materials removed no sign of any ACMs remain, where ceiling has been removed the timbers have been wire brushed and drilled out to ensure no asbestos debris or dust remain which they do not, Floors are concrete and have been wiped and vacuumed, walls are brick which have been wiped on the surface and are clean and debris free. NPU operating correctly and viewing panel in situ to allow full view. Area satisfactory for stage 2 pass.

STAGE 3 - Air Monitoring

29. Measurements required	1	30. No of measurements taken	1
31. NPU off and sealed	Yes	32. Areas of limited dust disturbance (state)	
ate)			N/A

STAGE 4 - Final assessment post enclosure/work area dismantling

33. Enclosure, airlocks or designated work area removed completely	Yes	34. Former enclosure or work area free of dust and debris	Yes
35. Transit route free from obvious ACM	Yes	36. Waste route free from obvious ACM	Yes
37. Where ACM remains by design, is it in a good condition?	N/A	38. Further remedial action required	N/A
39. Surrounding areas free from obvious ACM	Yes	40. Does the decontamination unit require testing	
unit require testing			N/A

Comments

All polythene has been removed satisfactory, no resemblance of any asbestos removal remains, area is clean and dust free, satisfactory for re-occupation.

For and on behalf of Tersus Consultancy Ltd.

Conor Hewett

Signature



Date 08 Dec 2018

Time 14:10

Contractor/Customer acknowledgement

Name Jamie Crabb

Company/Organisation Amstech Asbestos Removals Ltd

Signature



Date 08 Dec 2018

Certificate for Reoccupation

Job Number: J370870/CO02

Job Number J370870/CO02

Report Date 09 Dec 2018

Customer Name Amstech Asbestos Removals Ltd

Contractor Amstech Asbestos Removals Ltd, Unit F, Rich Industrial Estate, Avis Way, Newhaven, East Sussex, BN9 0DU

Customer Address Unit F, Rich Industrial Estate, Avis Way, Newhaven, East Sussex, BN9 0DU

Site Address Dove Lodge Community Resources Centre, 49 Beach Road, Littlehampton, West Sussex, BN17 5JG

Enclosure Location / Work Area 4 stage clearance carried out following the removal of Asbestos insulating board ceiling to the stairwell.

STAGE 1 OF 4 - PRELIMINARY SITE ASSESSMENT Précis of assessment criteria		
SCOPE OF WORK / METHOD STATEMENT PRESENT ALL WORKS WITHIN SCOPE COMPLETED WORK AREA ENCLOSURE AND AIRLOCKS INTACT AND CLEAN AIR EXTRACTION UNIT OPERABLE HYGIENE FACILITIES OPERATING AND CLEAN AREA SURROUNDING ENCLOSURE CLEAN TRANSIT ROUTE CLEAN WASTE ROUTE & DISPOSAL AREA CLEAN	SATISFACTORY	As Detailed on Report 'Preliminary Check of Site Conditions and Job Completeness'
STAGE 2 OF 4 - VISUAL INSPECTION Précis of assessment criteria		
AIR LOCKS CLEAR OF DEBRIS AND CLEAN ENCLOSURE / WORK AREA CLEAR OF DUST AND DEBRIS ALL SPECIFIED WORKS UNDERTAKEN	SATISFACTORY	As Detailed on Report 'Visual Inspection'
STAGE 3 OF 4 - AIR MONITORING Précis of assessment criteria		
DETERMINATION OF AIRBORNE FIBRE CONCENTRATION RESULTS TO THE CLEARANCE INDICATOR (0.01f/ml)	SATISFACTORY	As Detailed on Report 'Determination of Airborne Fibre Concentrations'
STAGE 4 OF 4 - FINAL SITE ASSESSMENT Précis of assessment criteria		
ENCLOSURE AND AIR LOCKS REMOVED FORMER WORK AREA FREE FROM DUST AND DEBRIS TRANSIT ROUTE CLEAN WASTE ROUTE CLEAN REMAINING ACMs IN GOOD CONDITION	SATISFACTORY	As Detailed on Report 'Final Assesment - Post Enclosure/Work Area Dismantling'
Reason for Sampling 4 stage clearance carried out following the removal of Asbestos insulating board ceiling to the stairwell.		

For and on behalf of Tersus Consultancy Ltd.

I CONFIRM THAT THE FORMER WORK AREA / ENCLOSURE LOCATION DESCRIBED IS CLASSED AS SAFE FOR REOCCUPATION

Signature



Conor Hewett

Notes: This certificate is not complete unless a copy of the results of the individual stages is appended.

CONTRACTOR / CUSTOMER ACKNOWLEDGEMENT

Signature



Jamie Crabb